

## Product Highlights

- **Easily expand your network**  
This convenient starter kit contains everything you need to extend your home network to where your wireless signals cannot reach.
- **Fast network performance**  
Up to 200 Mbps<sup>2</sup> for faster file sharing, lag free gaming and smooth HD video streaming.
- **Plug and play**  
No need for any IT or networking knowledge. Simply plug one adapter into any power outlet and connect it to your router, and the other adapter to your Internet-enabled device, such as computers, smart TVs or games consoles.
- **Secure network sharing**  
Secure your network from unwanted connections with a simple push of a button.
- **Compact design**  
Fits discreetly into your power outlet without blocking adjacent power sockets.



## DHP-309AV

# Powerline AV Mini Adapter Starter Kit

### Features

#### Standards

- IEEE 802.11n
- IEEE 802.11ac
- Powerline compatible with IEEE 1901 HomePlug AV

#### Connectivity :

- 10/100BASE-TX Ethernet ports with auto MDI/MDIX
- Simple button to activate Powerline encryption
- Power button (country-dependent) for Powerline
- Supports negotiation
- Supports 2.3x Flow Control

#### Security:

- AES data encryption for secure Powerline communications

The Powerline AV Mini Adapter Starter Kit uses your home's existing electrical wiring to extend your Internet connection<sup>1</sup>. It turns every power outlet into a high speed network connection. Compliant with the HomePlug AV standard, it provides network access to your computers, game consoles, televisions, and any other Internet-enabled devices throughout your home. Compact design allows the Mini Adapters to fit discreetly into your power outlet without blocking adjacent power sockets. Also available as a single unit (DHP-308AV).

### Ideal for bandwidth-intensive applications

This Powerline AV Mini Adapter Starter Kit is compliant with the HomePlug AV standard and capable of delivering data transfer rates at speeds of up to 200 Mbps<sup>2</sup>, faster than regular Powerline products. This rapid transmission speed makes it ideal for bandwidth-intensive applications, guaranteeing smooth HD video streaming, VoIP phone calls, and lag-free online gaming experiences. This device provides ample network bandwidth, enabling you to tap into existing electrical wiring for high-quality multimedia streaming. Additional Quality of Service (QoS) support prioritises multimedia traffic over other types of traffic on your network connection, ensuring faster transmission.

### Convenient setup and secure operation

Plugs directly into a power outlet, and does not require any additional cables. Extend your home network by connecting multiple devices in the farthest corners of your home, or attach a switch or wireless access point to the adapter to connect even more devices. The adapter implements 128-bit AES data encryption at the push of a button to protect your network from any intruders. With hassle-free plug and play installation, it's an ideal solution to create a wall-to-wall home network.

### Power-saving

During periods of inactivity, the Mini Adapters will go into sleep mode to save power, reducing power usage by more than 70%, allowing you to save energy automatically without sacrificing on performance.

### Reverse view

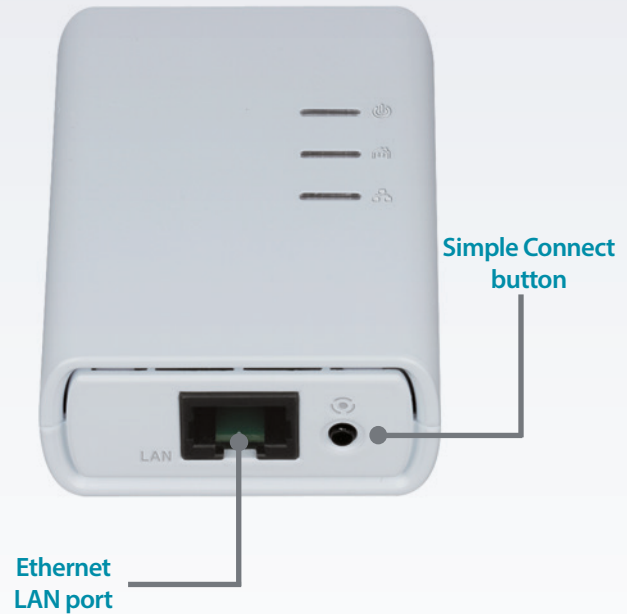

### Network diagram

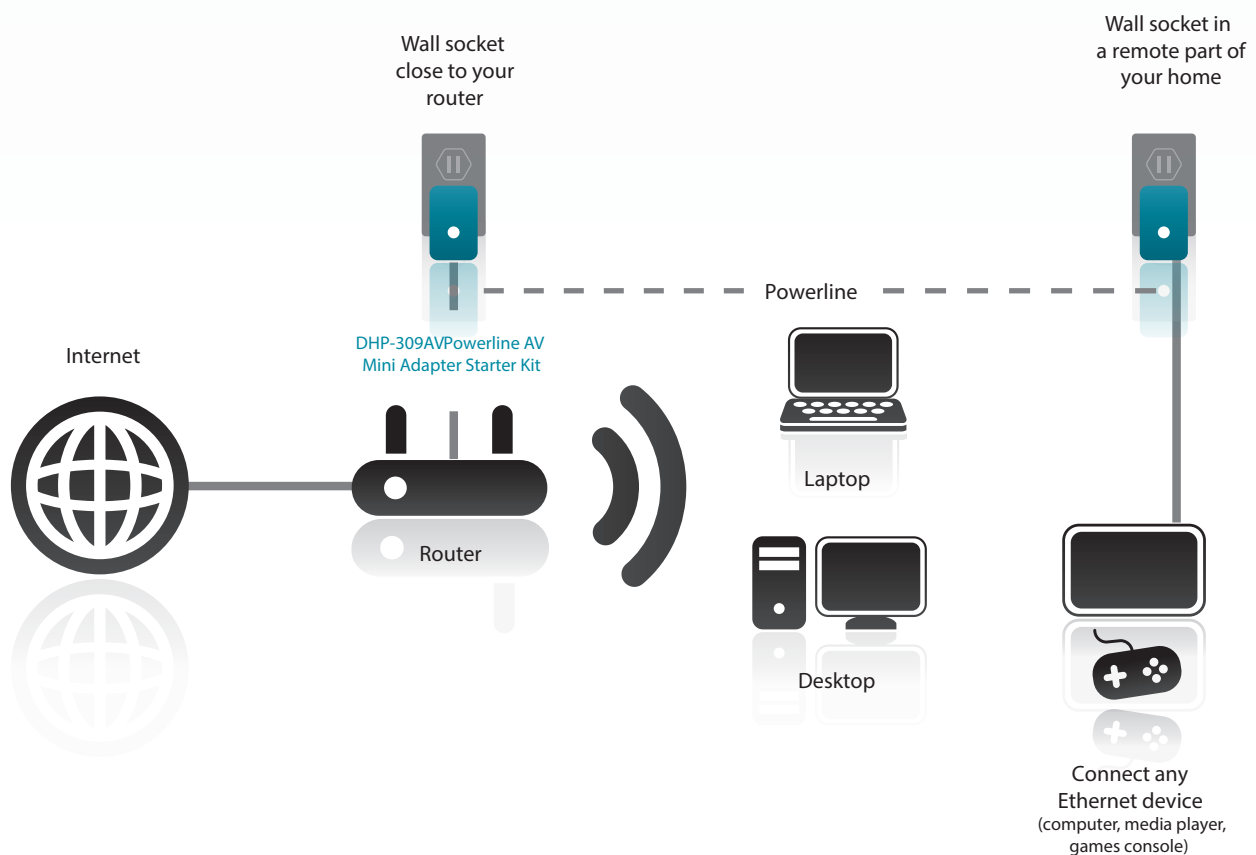

## Functions & Features

### General

Powerline interface	• Power plug (country/region-dependent)
Ethernet interface	• 10/100BASE-TX Fast Ethernet ports with audio MDI/ MDIX

### Functionality

Standards	• IEEE 802.3 • IEEE 802.3u	• HomePlug AV • IEEE 1901
Security	• 128-bit AES data encryption	
LEDs	• Power • Powerline	• Ethernet
Powerline modulation scheme	• OFDM symbol modulation	
Powerline frequency band	• 2 to 28MHz	
Data rate	• Powerline: transfer speeds up to 200 Mbps <sup>2</sup>	• Ethernet: 10/100 Mbps (Auto-Negotiation)

### Physical

Dimensions	• 70 x 52 x 26 mm (2.76 x 2.05 x 1.02 inches)	
Weight	• 110.7g (each adapter)	
Power	• Input: 100 to 240 V AC	• Maximum power consumption: 3.01 W
Power saving	• Power-saving mode supported	• Compliant with European Energy Using Product directive
Temperature	• Operating: 0 to 40°C (32 to 104°F)	• Storage: -10 to 70°C (14 to 158°F)
Humidity	• Operating: 10% to 90% non-condensing	• Storage: 5% to 90% non-condensing
Certifications	• FCC • CE LVD	• UL • CE EMC Class B

<sup>1</sup>Power outlets and electrical wiring must all be part of the same electrical system. Certain electrical conditions in your home, such as wiring condition and configuration, may affect the performance of this product. Additional D-Link Powerline AV series products are required to add new devices to the network. A minimum of two D-Link Powerline AV series products are required to create a network. Connecting this product to a power strip with a surge protector may adversely affect the performance of this product. For best results, plug the adapter directly into a wall outlet.

<sup>2</sup>Maximum throughput is based on theoretical transmission PHY rate. Actual data throughput will vary. Network conditions and environmental factors, including volume of traffic and network overhead, may lower actual data throughput rate. Interference from devices that emit electrical noise, such as vacuum cleaners and hair dryers, may adversely affect the performance of this product. This product may interfere with devices such as lighting systems that have a dimmer switch or a touch-sensitive on/off feature, short wave radios, or other Powerline devices that do not follow the HomePlug AV standard.



For more information: [www.dlink.com](http://www.dlink.com)

D-Link European Headquarters, D-Link (Europe) Ltd., D-Link House, Abbey Road, Park Royal, London, NW10 7BX. Specifications are subject to change without notice. D-Link is a registered trademark of D-Link Corporation and its overseas subsidiaries. All other trademarks belong to their respective owners. ©2014 D-Link Corporation. All rights reserved. E&OE.

November 2014

**D-Link**<sup>®</sup>  
Building Networks for People